



Land Use Plan

for Houston Spaceport



**HOUSTON
SPACEPORT**



January 2023



Vision Statement:

Houston Spaceport will serve as a catalyst to bring a wide range of aerospace-related industries, research, and education to the City of Houston while connecting the City to the rest of the world.



Over a nine-month period, the professional team worked with HAS representatives to develop a **Land Use Plan** that reflects the vision and provides a guide for future growth and development at the Houston Spaceport.



Axiom Space



Intuitive Machines



Collins Aerospace

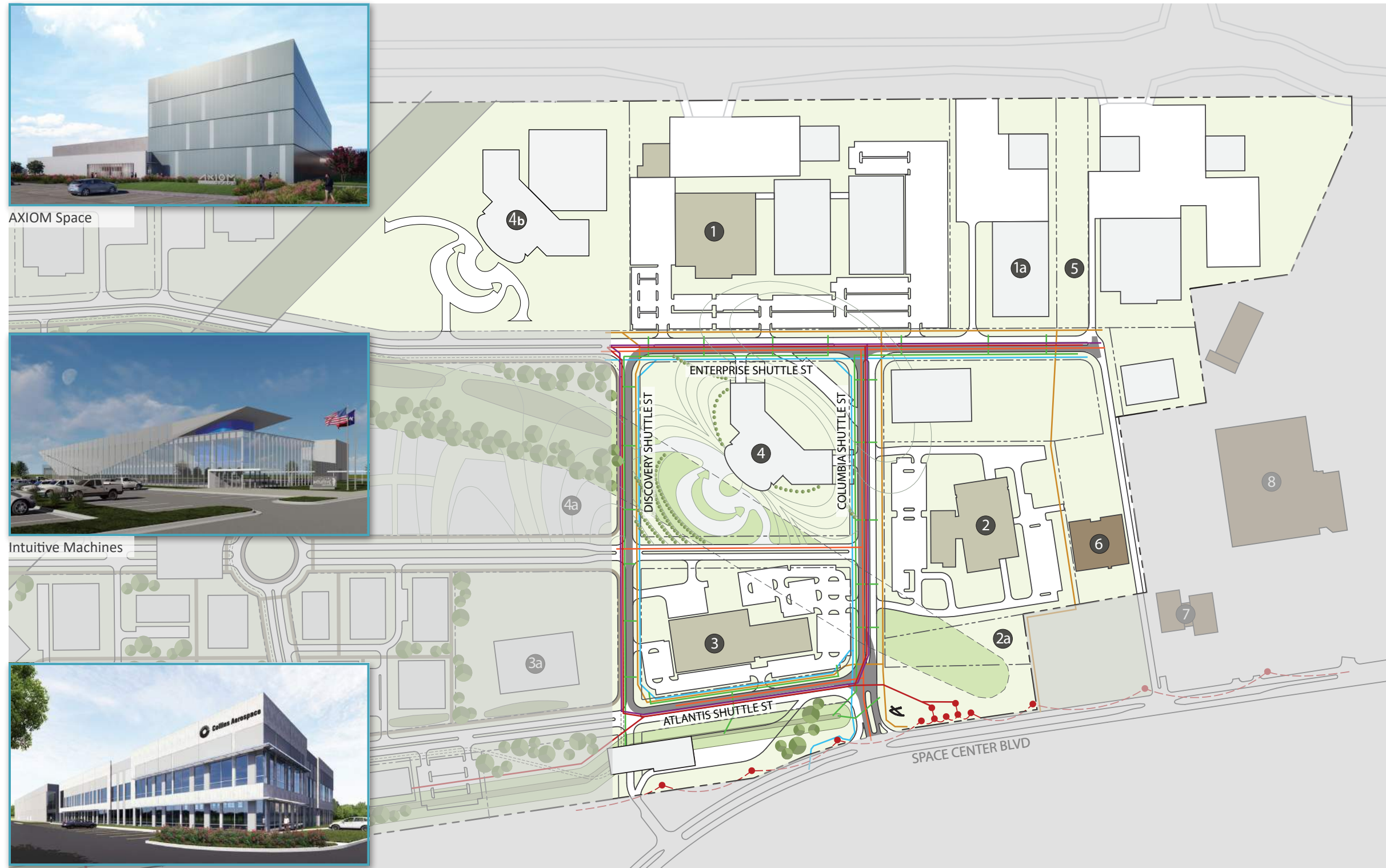

LEGEND

- ① Axiom Space (Under Construction)
 - ①a Axiom Space Option
 - ② Intuitive Machines (Under Construction)
 - ②a Intuitive Machines Option
 - ③ Collins Aerospace (Under Construction)
 - ③a Collins Aerospace Option
 - ④ Aerospace Training Institute (Proposed)
 - ④a Aerospace Training Institute Future Campus Expansion
 - ⑤ Future Tunnel Easement
 - ⑥ HASC (Existing)
 - ⑦ Boeing (Existing)
 - ⑧ NASA Neutral Buoyancy Laboratory (Existing)
- Phase 1 Tenant Buildings Under Construction
 - Potential Future Buildings
 - Existing Buildings

PHASE 1 INFRASTRUCTURE IN-PLACE

- Phase 1 Roadway Pavement
- - - Electrical Overhead
- - - Electrical Ductbank
- Potable Water
- Sanitary Sewer
- Natural Gas
- Stormwater
- Communications Ductbank

Figure 2.1 Phase 1 Development and In-place Infrastructure

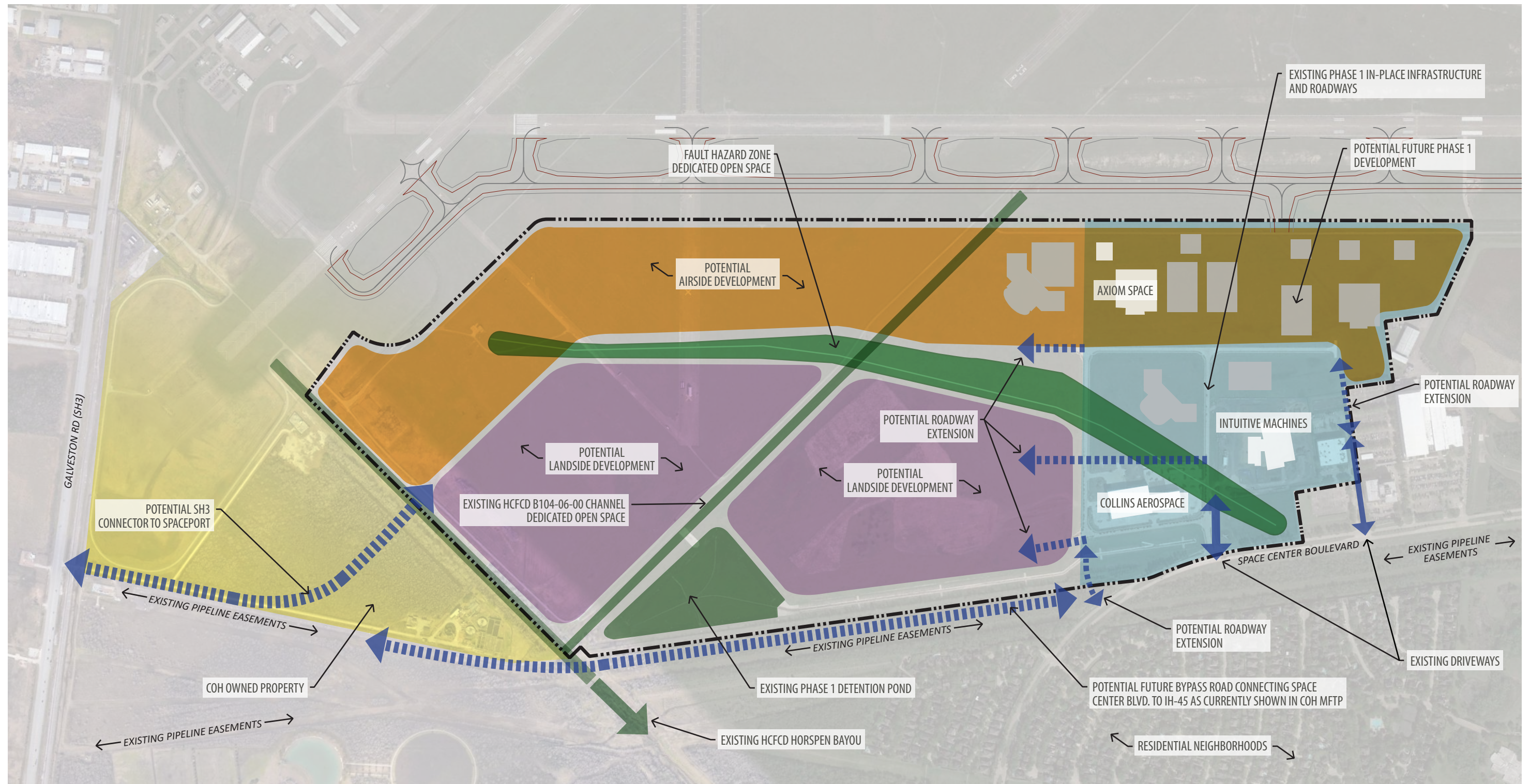

Figure 4.1 Opportunities & Constraints



Table 6.1 Future Land Use Areas by Design Sector

Zone Description	Acres
a Airside Zone	145.5
b Phase I Zone	67.2
c Walkable Core Zone	39.2
d SW Landside Zone	30.9
e Bypass Frontage Zone	9.1
f ROW + Open Space + Detention	142.7
Total Acres	434.6

DESIGN SECTORS

The preferred land use plan has been organized by sectors. The Figure on this page presents each of the different sectors by color within the Houston Spaceport site boundary.

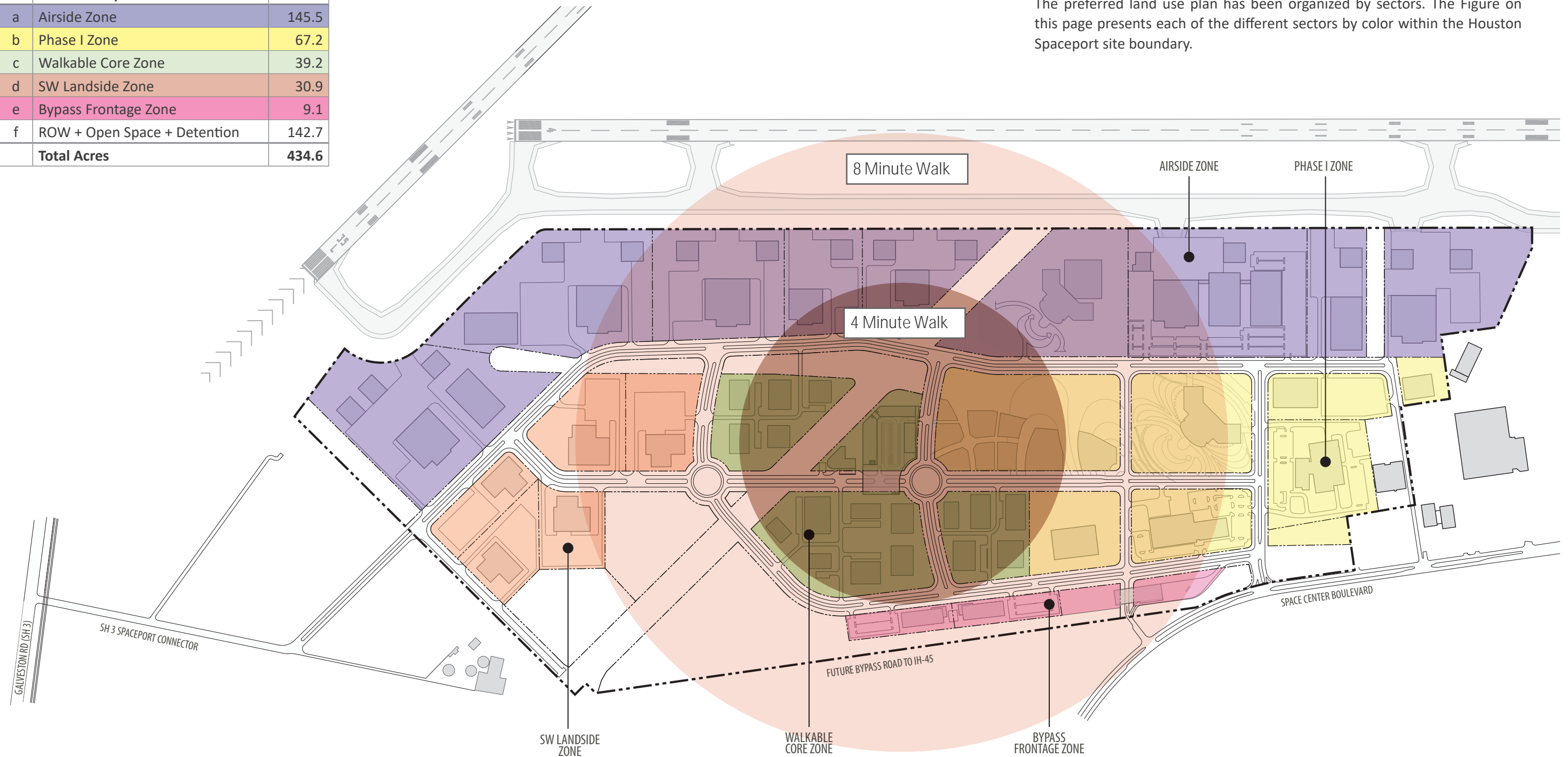
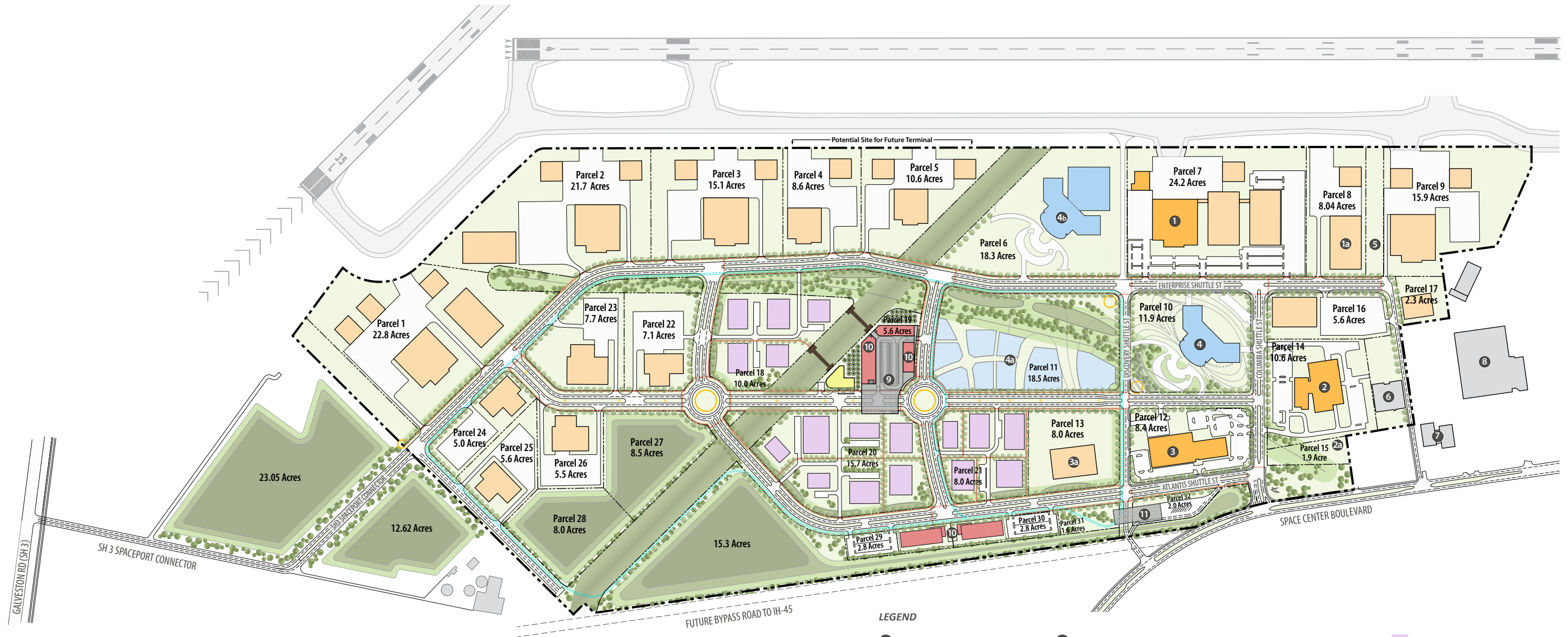
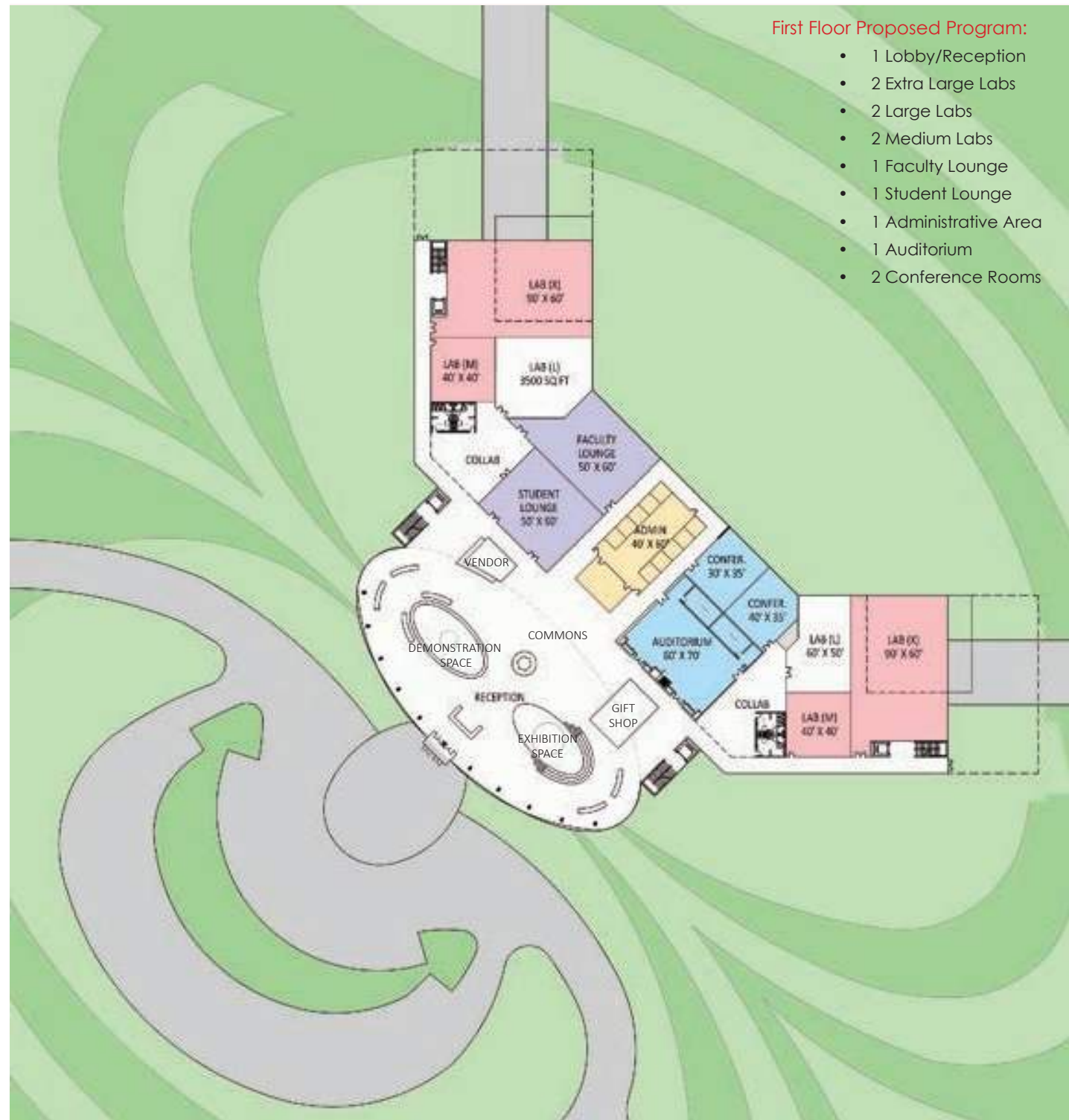

Figure 6.1 Design Sectors



LEGEND

- | | | | |
|--|---|-----------------------------------|-------------------------------------|
| ① Axiom Space | ⑤ Future Tunnel Easement | — Multi-use Path | ■ Future Office/Lab/R&D |
| ①a Axiom Space Option | ⑥ HASC | - - - Future Transit Easement | ■ Future Educational |
| ② Intuitive Machines | ⑦ Boeing | ○ Public Art | ■ Future Educational Expansion |
| ②a Intuitive Machines Option | ⑧ NASA Neutral Buoyancy Laboratory | ■ Drainage/Detention | ■ Future Retail |
| ③ Collins Aerospace | ⑨ Mixed-use HUB/Garage (533 Spaces/Floor) | ■ Open Space | ■ Future Hotel |
| ③a Collins Aerospace Option | ⑩ Retail | ■ Existing Assembly/Manufacturing | ■ Future Transportation HUB/Parking |
| ④ Aerospace Training Institute | ⑪ Transit HUB | ■ Future Assembly/Manufacturing | ● Trees |
| ④a Aerospace Training Institute Future Campus Expansion | | | |
| ④b Texas Southern University Center for Aerospace and Aviation | | | |



Schematic Design Program Layout for the Aerospace Institute Building First Floor

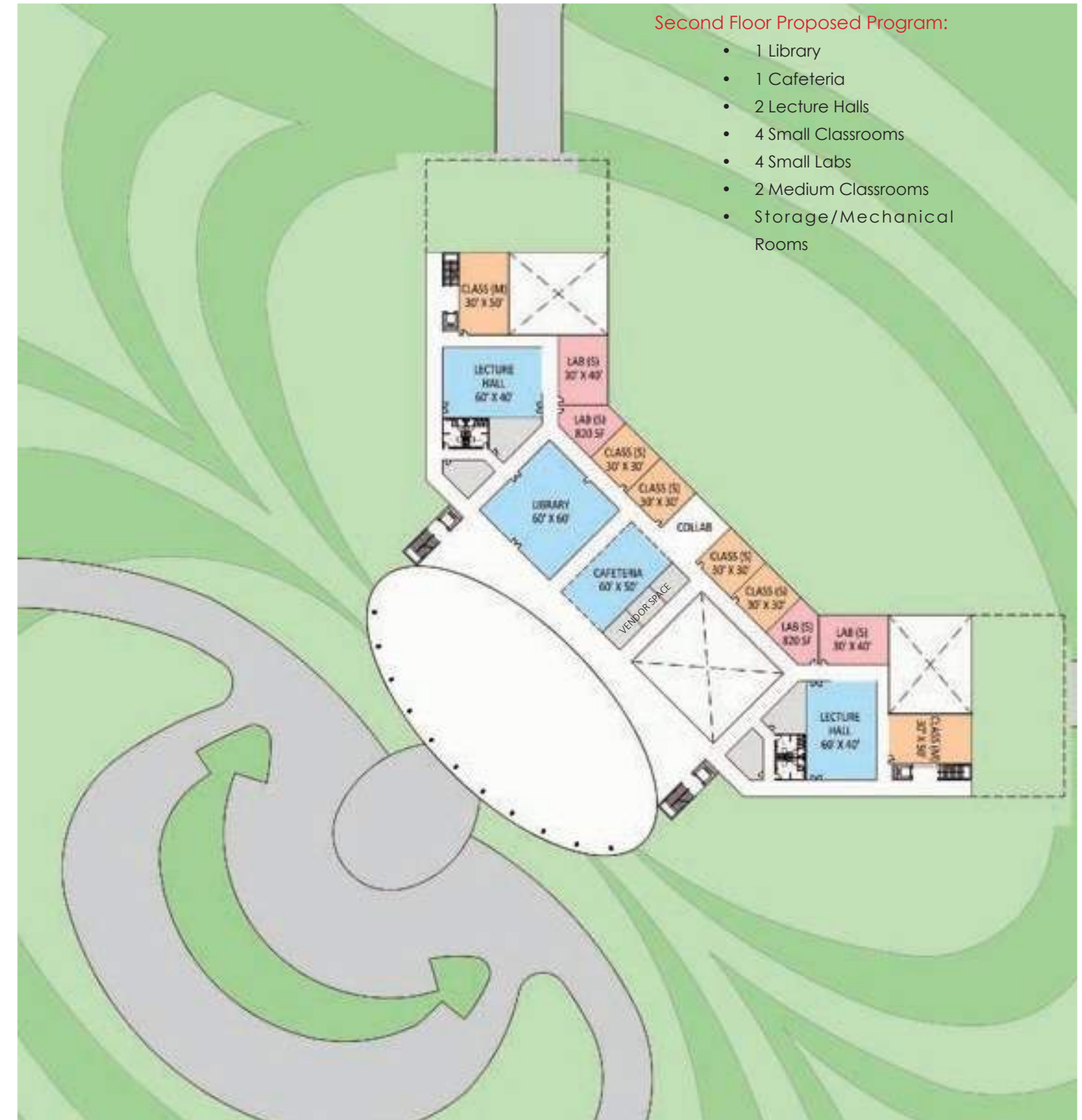

Schematic Design Program Layout for the Aerospace Institute Building Second Floor





